

GIPFEL FIGURE OF EIGHT DESCENDER

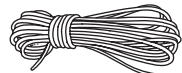
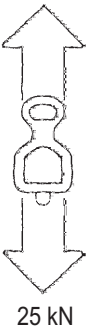

$10 \leq \varnothing \leq 12 \text{ mm}$

Rope (core + sheath) static,
semi-static (EN 1891)
or dynamic (EN 892)

This is a Type 2 braking device used for
belaying and abseiling without a function
to adjust the friction.

This descender conforms to EN15151-2
and UIAA 129 standards.

Individually tested!

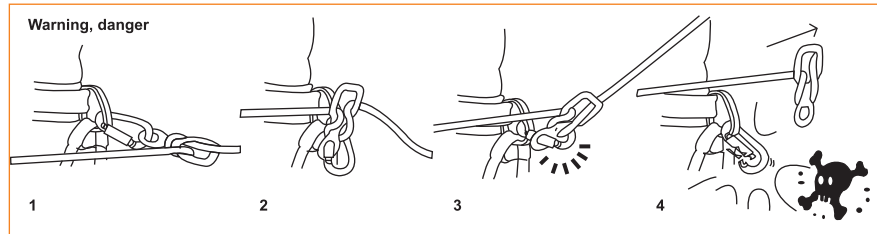
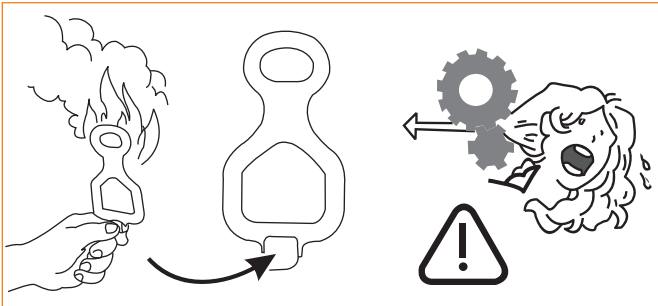
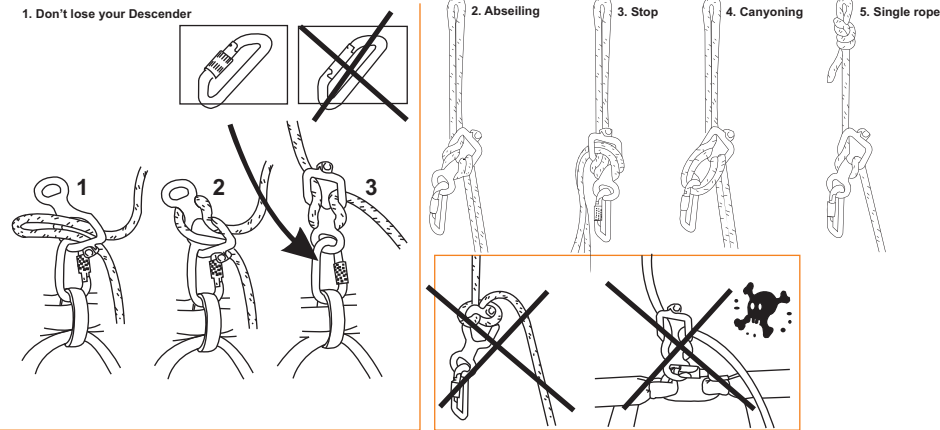
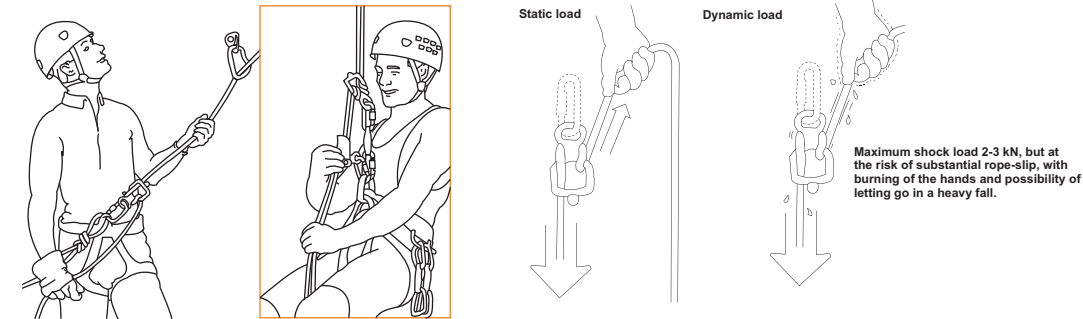

13. Belaying the leader

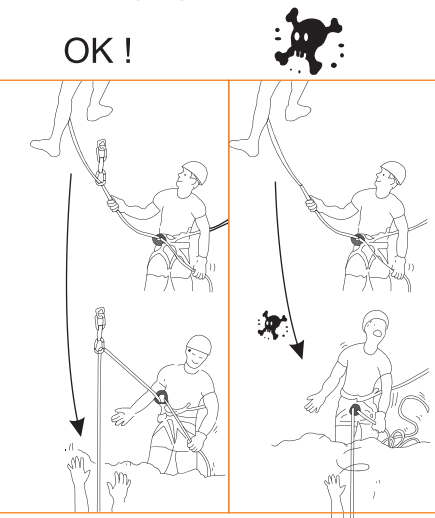

14. Belaying the second

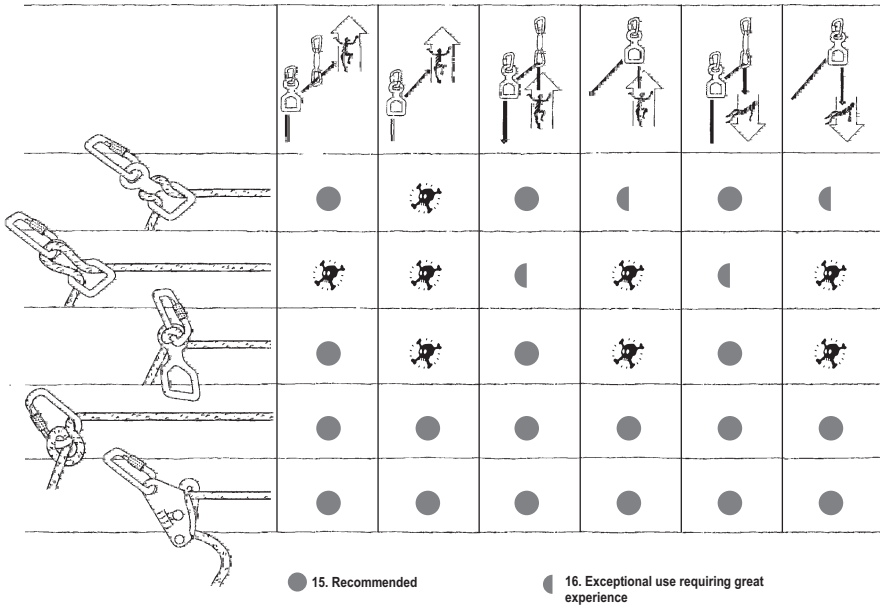
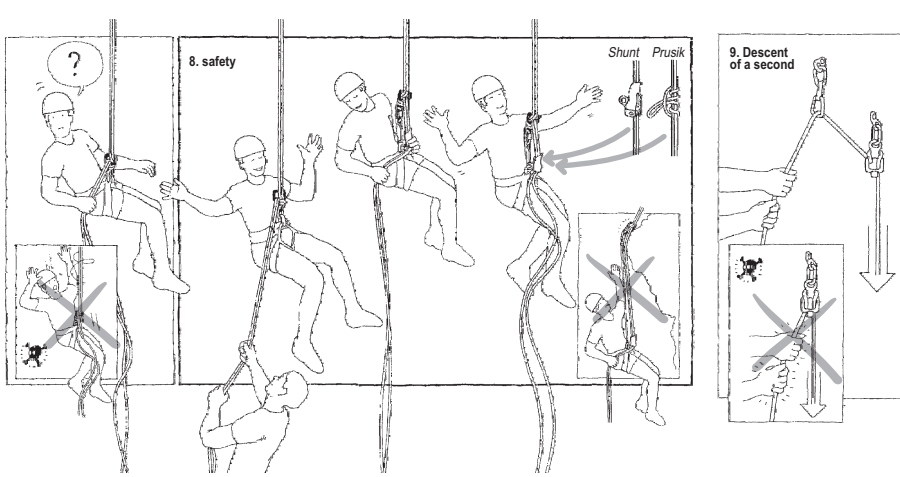
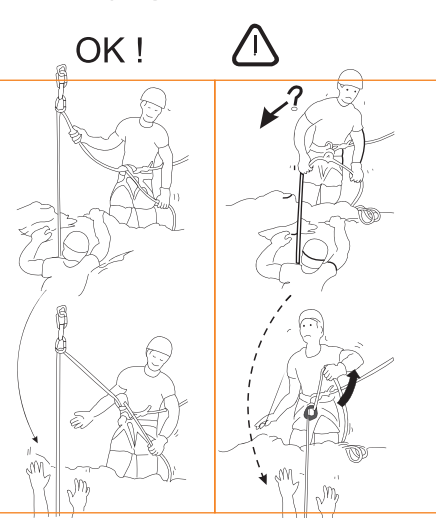

15. Recommended

16. Exceptional use requiring great
experience



**GIPFEL FIGURE OF EIGHT DESCENDER IS A TYPE 2 BRAKING
DEVICE USED FOR BELAYING AND ABSEILING WITHOUT A
FUNCTION TO ADJUST THE FRICTION.**

**CAUTION: EFFECTIVENESS OF THIS BRAKING DEVICE
DEPENDS ON THE ROPE DIAMETER (RECOMMENDED 11.5-
12MM ROPE), SLIPPERINESS OF THE ROPE, DAMPNES OF
THE ROPE AND ALSO ON THE SKILL LEVEL OF THE CLIMBER.**

**IT IS THE RESPONSIBILITY OF EVERY USER TO FAMILIARIZE
HIMSELF WITH THE BRAKING EFFECT IN A SAFE AND
CONTROLLED ENVIRONMENT BEFORE THE ACTUAL USE.**

**THE FREE END OF THE ROPE SHALL BE CONTROLLED BY THE
BRAKING HAND AT ALL TIMES!**

Read this notice carefully and keep all instructions and
information on the proper use and applications of the
product(s). Only the technique shown in the diagrams that are
not crossed out are authorized.
All other uses are excluded: danger of death. A few examples
of misuses and forbidden uses are also represented (shown
in the crossed out diagrams or with the "skull and
crossbones" symbol). Many other types of misuses exist and
it is impossible to enumerate or even imagine all of them. In
case of doubt or difficulty in understanding, contact GIPFEL.
Activities at height are dangerous and may lead to severe
injury or even death. Gaining an adequate apprenticeship in
appropriate technique and methods of protection is your own
responsibility.
Your personally assume all risks and responsibility for all
damage, injury or death which may occur during or following
incorrect use of our product in any manner whatsoever. If you
are not able, or not in a position to assume this responsibility
or to take this risk, do not use this equipment.

Use

This product must only be used by competent and
responsible person, or those placed under the direct and
visual control of a competent and responsible person.
Personal protective equipment (PPE) is to be used only on or
with energy absorbing system (for example dynamic ropes,
energy absorbers, etc). Verify that this product is compatible
with the other components of your system. See the instruction
specific to the products. To prolong the life of this product,
care is necessary, when transporting as well as when using it.
Avoid impacts, or rubbing against abrasive surfaces or sharp
edges.

It is up to the user to foresee situation requiring rescue in
case of difficulties encountered while using this product.

Major fall and impact

Do not continue to use this product after a major fall or a
major impact (fall of the product or impact on the product).
Even though no external signs may be visible, a deformation
may restrict its operation or internal damage may have
occurred, thus reducing its strength. Do not hesitate to
contact GIPFEL in case of doubt.

Checking and safety

Do not hesitate to retire a product showing signs of wear
which might affect its strength, or restrict its operation. For
your safety we advise you to adopt a 3-level checking
schedule.
-Before and after each use it is necessary to check the
condition of the product.
-During use, it is important to regularly monitor the condition
of the product and of its connections to the other elements of
the system.
-A more thorough inspection must be carried out by a
competent inspector (approximately every three months).
For more safety and better control of you equipment, we
advise you to keep an "inspection record" for each product.
It is preferable to personally issue each user of PPE with his
or her own set of equipment.

Storage and Ageing

**Maximum life time of this descender is 2 years, taking
into account the development of new techniques and the
compatibility of products with our products.**

This life time depends on the intensity, the frequency of use
and the environment where the product is used.

- 1.In exceptional circumstances, wear or damage could occur
on the first use which reduces the lifetime of the product to
that one single use.
- 2.Certain environmental elements will considerably accelerate
wear: salt, sand, snow, ice, moisture, chemicals, etc (list not
exhaustive).
- 3.Store only in corrosive free environment and from sharp objects.
If the descender is found to have cracks or bends, do NOT use
the product anymore.
- 4.GIPFEL recommends these products undergo an in-depth
inspection every 3 months.

If the check is passed, use is approved for another 3 months.
If the test fails, retire the product immediately.

PRICE